

INGENIERIA, CONSTRUCCION Y COMERCIO S.A.

«RELIABLE SOLUTIONS BASED ON EXPERIENCE»



ENGINEERING AND CONSULTING SERVICES TO IMPROVE : PROFITS ,SAFETY AND RELIABILITY OF EXISTING INDUSTRIAL FACILITIES .

- Process Optimization
- Risk Analysis
- Post-Damages Recovery (Operationals , Earthquakes, Wind, ,Snow)
- Financial and Scheduling Progress Reports during Maintenance Shut –downs.
- Environmental Projects to attend Regulation Changes.
- Reliability Improvement for Maintenance Programs.
- Diagnosis using Non Destructive Tests .
- Working Conditions Safety Improvement

PROJECT ENGINEERING (Own Execution and third party Project Revision and Validation)

- Project Engineering (Process, Equipment, Piping ,Civil ,Structural , Electricity and Instruments)
 - **Conceptual** :Process Assessment and Preliminary Investment
 - **Basic** :Major project definition documents and Investment Estimation
 - **Detail** : For Construction & Erection , Commissioning, Start-up.
 - **Preliminary Projects** :To improve the estimation of EPC- Projects .
- Equipment and Material Suppliers Inspection –
- Seismic Analysis and Design of Equipment and Structures.*
- Seismic Design Validation for equipment and Structures (South America Pacific Coast)*
- Vibration Reduction Design for equipment and Structures .*

ENGINEERING CONSULTING FOR CONSTRUCTION & ERECTION

- Preparation of Inquiries for Construction and Erection
- Financial and Scheduling Progress Reports during Construction and Erection.
- Technical Solutions for Complex Equipment and Structures Erection.
- Engineering Inspection during Construction and Erection .

CHILE

Viña del Mar

Concón

Concepción

www.ltmingenieria.cl

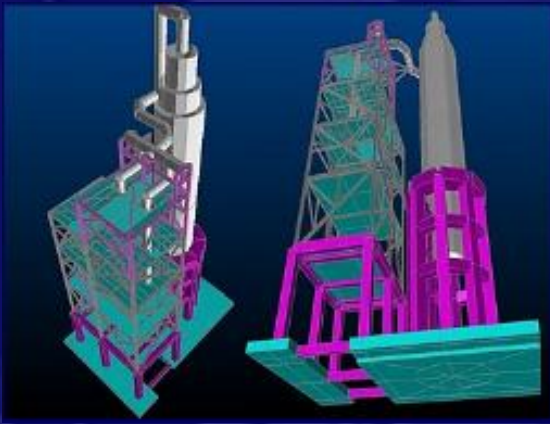

Seismic Analysis of Equipment and Structures



*Industrial Facilities Diagnosis using Non Destructive Tests .
(Visual, Thermographic, Ultrasonic, Drones , others).*



Headquarters

Paseo Cousiño N°3 Oficina N°8
Viña del Mar, Región de Valparaíso. Fono: 32-2683288 / 32-2683951

Branch Offices:

Central

San Agustín 1397 Oficina N°2 y 3 Concón, Región de Valparaíso. Fono: 32-2814421 /32-2813065

South

Caupolicán N°346 Oficina E Concepción, Región del Bío Bío.
Fono: 41-2252621

Contact : gerencia@ltmingeneria.cl

www.ltmingeneria.cl